

Equipo de riego / 4 tiempos



22MOTOB0052CH



22MOTOB0053CH



22MOTOB0054CH

| Código | Número | Potencia |
|---------------|--------|----------|
| 22MOTOB0052CH | GGP2 | 5.5 HP |
| 22MOTOB0053CH | GGP3 | 6.5 HP |
| 22MOTOB0054CH | GGP4 | 9 HP |

Modelos: GGP2 / GGP3 / GGP4

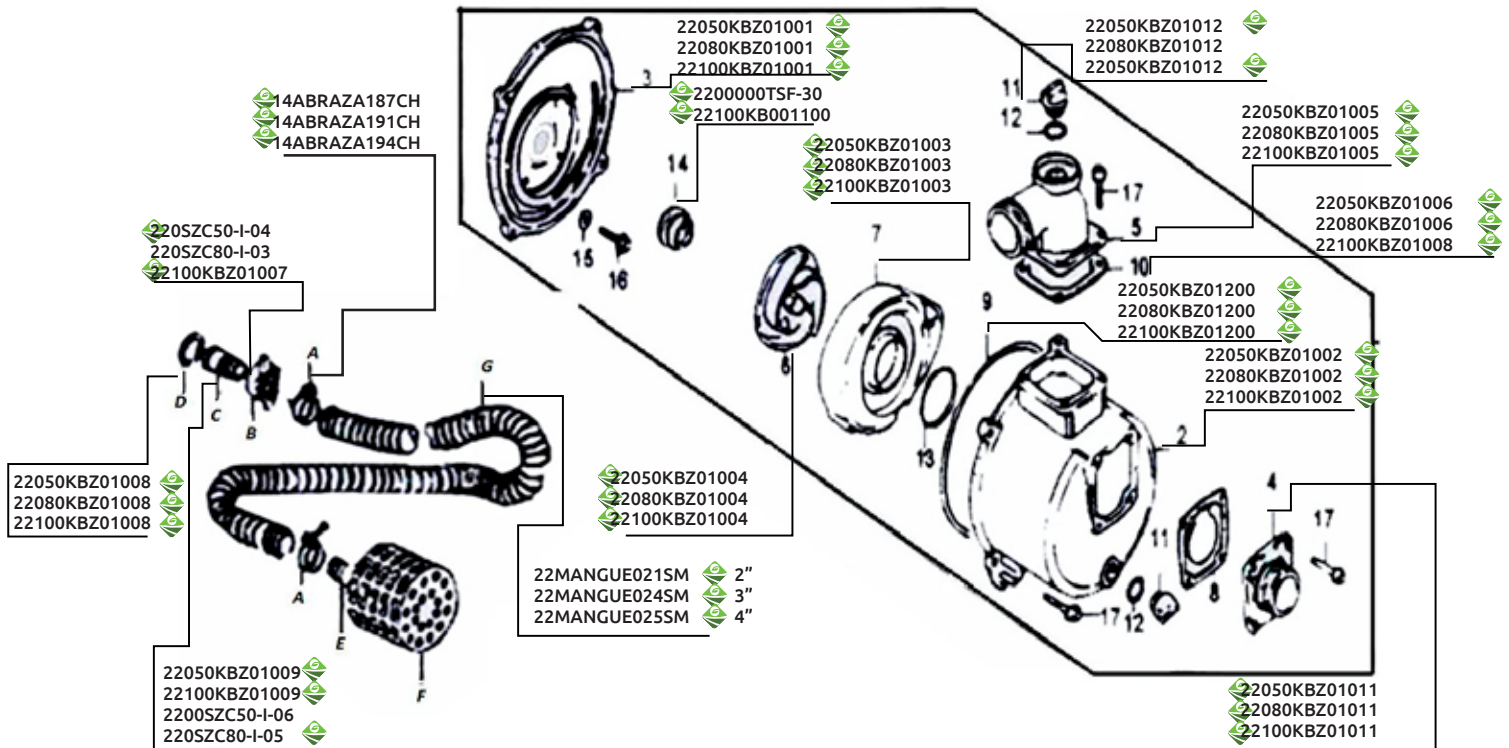

| No. esquema | Descripción | 5.5 HP GGP2 | 6.5 HP GGP3 | 9 HP GGP4 |
|-------------|-----------------|---------------|---------------|---------------|
| 2 | Caja bomba | 22050KBZ01002 | 22080KBZ01002 | 22100KBZ01002 |
| 3 | Respaldo caja | 22050KBZ01001 | 22080KBZ01001 | 22100KBZ01001 |
| 4 | Tapa succión | 22050KBZ01011 | 22080KBZ01011 | 22100KBZ01011 |
| 5 | Tapa salida | 22050KBZ01005 | 22080KBZ01005 | 22100KBZ01005 |
| 6 | Impulsor | 22050KBZ01004 | 22080KBZ01004 | 22100KBZ01004 |
| 7 | Tapa impulsor | 22050KBZ01003 | 22080KBZ01003 | 22100KBZ01003 |
| 9 | Sello o ring | 22050KBZ01200 | 22080KBZ01200 | 22100KBZ01200 |
| 10 | Junta | 22050KBZ01006 | 22080KBZ01006 | 22100KBZ01008 |
| 11 | Tapón | 22050KBZ01012 | 22080KBZ01012 | 22050KBZ01012 |
| 14 | Sello mecánico | 2200000TSF-30 | 2200000TSF-30 | 22100KB001100 |
| A | Abrazadera | 14ABRAZA187CH | 14ABRAZA191CH | 14ABRAZA194CH |
| B | Tuerca conexión | 220S50-I-04 | 220S50-I-03 | 22100KBZ01007 |
| C | Tubo conexión | 22050KBZ01009 | 220S50-I-05 | 22100KBZ01009 |
| D | Junta conexión | 22050KBZ01008 | 22080KBZ01008 | 22100KBZ01008 |
| E | Conector | | | |
| G | Manguera | 22MANGUE021SM | 22MANGUE024SM | 22MANGUE025SM |