

Rodamiento de aguja

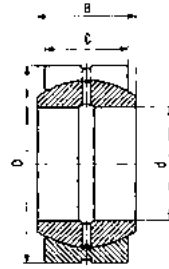
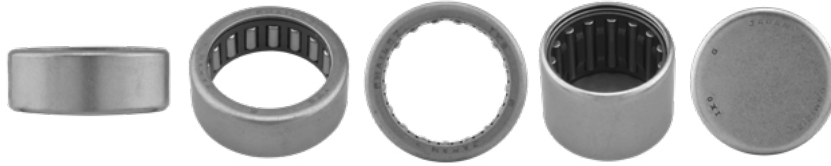

COJINETES ESFÉRICOS

SBB

Código	Descripción	Peso (Kg)	d mm	Dimensiones Fw mm	D mm	C mm	Precio
13SBB8—IK	SBB 8 1/2X7/8X.437 "IKO"	0.02	12.7	22.225	11.1	9.52	\$285.36
13SBB8—TA	SBB 8 1/2X7/8X.437 "GIM"	0.02	12.7	22.225	11.1	9.52	\$97.44
13SBB10—IK	SBB 10 5/8X1.1/16X.547 "IKO"	0.036	15.875	26.988	13.89	11.91	\$412.96
13SBB10—TA	SBB 10 5/8X1.1/16X.547 "GIM"	0.036	15.875	26.988	13.89	11.91	\$146.16
13SBB12—IK	SBB 12 3/4X1.1/4X.656 "IKO"	0.057	19.05	31.75	16.66	14.27	\$337.56
13SBB12—TA	SBB 12 3/4X1.1/4X.656 "GIM"	0.057	19.05	31.75	16.66	14.27	\$200.68
13SBB14—IK	SBB 14 7/8X1.7/16X.765 "IKO"	0.088	22.225	36.512	19.43	16.66	\$526.64
13SBB14—TA	SBB 14 7/8X1.7/16X.765 "GIM"	0.088	22.225	36.512	19.43	16.66	\$220.40
13SBB16—IK	SBB 16 1"X1.5/8X.875 "IKO"	0.125	25.4	41.275	22.22	19.05	\$580.00
13SBB16—TA	SBB 16 1"X1.5/8X.875 "GIM"	0.125	25.4	41.275	22.22	19.05	\$226.20
13SBB20—IK	SBB 20 1.1/4X2X1.093 "IKO"	0.234	31.75	50.8	27.76	23.8	\$668.16
13SBB20—TA	SBB 20 1.1/4X2X1.093 "GIM"	0.234	31.75	50.8	27.76	23.8	\$226.20
13SBB28—IK	SBB 28 1.3/4X2.13/16X1.531 "IKO"	0.649	44.45	71.438	38.89	33.32	\$1,717.96
13SBB28—TA	SBB 28 1.3/4X2.13/16X1.531 "GIM"	0.649	44.45	71.438	38.89	33.32	\$368.88

Código	Equivalencias							
	TORRINGTON WITHOUT SEAL ..SF..	TORRINGTON WITH SEALS ..SF..TT(SS)	R.B.C. WITHOUT SEAL B..L	R.B.C. WITH SEALS B..LSS	INAELGES WITHOUT SEAL GE..ZO	INAELGES WITH SEALS GE..ZO-2RS	SKF WITHOUT SEAL GEZ..ES	SKF WITH SEALS GEZ..ES-2RS
13SBB10—IK	6SF10	—	B10-L	—	GE15ZO	—	GEZ010ES	—
13SBB10—TA	6SF10	—	B10-L	—	GE15ZO	—	GEZ010ES	—
13SBB12—IK	7SF12	7SF12-TT	B12-L	B12-LSS	GE19ZO	GE19ZO-2RS	GEZ012ES	—
13SBB12—TA	7SF12	7SF12-TT	B12-L	B12-LSS	GE19ZO	GE19ZO-2RS	GEZ012ES	—
13SBB14—IK	8SF14	8SF14-TT	B14-L	B14-LSS	GE22ZO	GE22ZO-2RS	GEZ014ES	—
13SBB14—TA	8SF14	8SF14-TT	B14-L	B14-LSS	GE22ZO	GE22ZO-2RS	GEZ014ES	—
13SBB16—IK	10SF16	10SF16-TT	B16-L	B16-LSS	GE25ZO	GE25ZO-2RS	GEZ100ES	GEZ100ES-2RS
13SBB16—TA	10SF16	10SF16-TT	B16-L	B16-LSS	GE25ZO	GE25ZO-2RS	GEZ100ES	GEZ100ES-2RS
13SBB20—IK	12SF20	12SF20-TT	B20-L	B20-LSS	GE31ZO	GE31ZO-2RS	GEZ104ES	GEZ104ES-2RS
13SBB20—TA	12SF20	12SF20-TT	B20-L	B20-LSS	GE31ZO	GE31ZO-2RS	GEZ104ES	GEZ104ES-2RS
13SBB28—IK	17SF28	17SF28-TT	B28-L	B28-LSS	GE44ZO	GE44ZO-2RS	GEZ112ES	GEZ112ES-2RS
13SBB28—TA	17SF28	17SF28-TT	B28-L	B28-LSS	GE44ZO	GE44ZO-2RS	GEZ112ES	GEZ112ES-2RS
13SBB8—IK	5SF8	—	B8-L	—	GE12ZO	—	GEZ008ES	—
13SBB8—TA	5SF8	—	B8-L	—	GE12ZO	—	GEZ008ES	—

Venta por pieza

Rodamiento de aguja



Código	Descripción	Precio
13B65—TR	B-65 (S-65) CASQUILLO AGUJAS TORRINGTON	\$25.52
13BCH06604TAM	BALERO PARA ALTERNADOR DB-260000 BCH-06604P "GIM"	\$38.28
13LBE122232YK	LBE-122232 (SDE12Y) CASQUILLO BOLAS PLASTICO EASE	\$291.16
13LBE162636YK	LBE-162636 (SDE16Y) CASQUILLO BOLAS PLASTICO EASE	\$371.20
13LM101929NIK	LM-101929 (SDM-10) CASQUILLO BOLAS EASE	\$254.04
13LM406080UU	LM-406080 UU (SDM-40UU) CASQUILLO BOLAS	\$2,201.68
13NKIS85—ND	NA-2085 NKIS-85 RODAMIENTO AGUJAS "NDL"	\$1,142.60
13NUTR35—ND	FGU 35-72 NUTR-35 RODAMIENTO DE APOYO "NDL"	\$756.32
13RC040708-CH	RC040708 CASQUILLO PARA CLUTCH "GIM"	\$29.00
13RC040708-FS	RC040708FS CASQUILLO PARA CLUTCH "GIM"	\$29.00
13RC061008-CH	RC061008 CASQUILLO PARA CLUTCH "GIM"	\$44.08
13RC061008-FS	RC061008FS CASQUILLO PARA CLUTCH "GIM"	\$51.04
13RC081208-CH	RC081208 CASQUILLO PARA CLUTCH "GIM"	\$30.16
13RC081208-FS	RC081208FS CASQUILLO PARA CLUTCH "GIM"	\$51.04
13RC101410-FS	RC101410FS CASQUILLO PARA CLUTCH "GIM"	\$51.04

Venta por pieza

Código	Descripción	Precio
13RC101410-TA	RC101410 CASQUILLO PARA CLUTCH 5/8X7/8X5/8 "GIM"	\$40.60
13RC121610-CH	RC121610 CASQUILLO PARA CLUTCH "GIM"	\$58.00
13RC162110-CH	RC162110 CASQUILLO PARA CLUTCH "GIM"	\$61.48
13RC162110-FS	RC162110FS CASQUILLO PARA CLUTCH "GIM"	\$64.96
13RCB061014CH	RCB061014 CASQUILLO PARA CLUTCH 3/8X5/8X7/8 "GIM"	\$64.96
13RCB061014FS	RCB061014FS CASQUILLO PARA CLUTCH "GIM"	\$69.60
13RCB081214CH	RCB081214 CASQUILLO PARA CLUTCH "GIM"	\$71.92
13RCB081214FS	RCB081214FS CASQUILLO PARA CLUTCH "GIM"	\$73.08
13RCB101416FS	RCB101416FS CASQUILLO PARA CLUTCH "GIM"	\$81.20
13RCB101416TA	RCB101416 CASQUILLO PARA CLUTCH 5/8X7/8X1 "GIM"	\$88.16
13RCB121616CH	RCB121616 CASQUILLO PARA CLUTCH "GIM"	\$61.48
13RCB121616FS	RCB121616FS CASQUILLO PARA CLUTCH "GIM"	\$104.40
13RCB162117CH	RCB162117 CASQUILLO PARA CLUTCH "GIM"	\$112.52
13RCB162117FS	RCB162117FS CASQUILLO PARA CLUTCH "GIM"	\$88.16

Venta por pieza

